

Stamp
here



Organized by

Association of
Private Medical Specialists
of Hong Kong

Co-organizers



The Society of
Anaesthetists
of Hong Kong



Hong Kong
Society of
Breast Surgeons



The Hong Kong
Cancer Therapy
Society



Hong Kong
College of
Cardiology



American College of
Chest Physicians
(HK & Macau Chapter)



Hong Kong
Society of
Clinical Oncology



Hong Kong
Society for
Coloproctology



Hong Kong
Society of
Critical Care
Medicine



Hong Kong
Dental
Association



The Hong Kong
Society of
Diagnostic
Radiologists



Hong Kong
Society of
Endocrinology,
Metabolism and
Reproduction



The Hong Kong
Society of
Gastroenterology



The Hong Kong
Society of
Geriatrics



The Hong Kong
Society of
Haematology



Hong Kong
Society of
Hepatobiliary and
Pancreatic Surgery



Hong Kong
IBD
Society



The Hong Kong
Society for
Infectious
Diseases



The Hong Kong
Society of
Interventional
Radiology



Hong Kong
Association for the
Study of
Liver Diseases



The Hong Kong
Medical
Association



Hong Kong
Society of
Medical Genetics



Hong Kong
Society of
Minimal Access
Surgery



The Hong Kong
Neurosurgical
Society



The
Obstetrical and
Gynaecological
Society of Hong Kong



Hong Kong
Ophthalmological
Society



The Hong Kong
Association of
Oral and Maxillofacial Surgeons



The Hong Kong
Orthopaedic
Association



Hong Kong Society of
Otorhinolaryngology,
Head & Neck Surgery



Hong Kong
Society of
Palliative Medicine



Hong Kong Society of
Plastic, Reconstructive and
Aesthetic Surgeons



The Hong Kong
Society of
Psychiatrists



The Hong Kong
Society of
Rheumatology



Hong Kong
Thoracic
Society



Hong Kong Society of
Upper
Gastrointestinal
Surgeons



Hong Kong
Urogynaecology
Association



Hong Kong
Urological
Association

www.mmmcon.com

MULTI-SPECIALTY MEDICAL MEGA CONFERENCE 2.0



Multi-specialty Content
Excellent Quality
Great Faculty
All Doctors Welcome

14-15 April 2012

Ball Room | Langham Place Hotel | Mongkok

24 sessions

Acute Stroke Management
Arthritis
Back Pain
Breast Cancer in Young Women
Cancer Screening
Cardiology
Colorectal
Critical Care

Geriatric Fracture
Gynaecological Oncology & Urogynaecology
Implant Dentistry
Irritable Bowel Syndrome
Dementia
Diabetes
Gastro-esophageal Reflux Disease
Genetics & Diseases

Liver Diseases
Lung Cancer
Minimal Access Surgery
Ophthalmology
Oral & Maxillofacial Surgery
Palliative Care
Prostate Cancer
Sleep Apnoea

Registration fee

HK\$100 | Member of all Organizing Societies

HK\$200 | Non-member

HK\$100 | Nursing Colleagues

CME, CPD & CNE accredited

For registration and detailed programme, please visit:

www.mmmcon.com

Enquiry

Ms May Cheung

Email | info@mmmcon.com

MULTI-SPECIALTY
MEDICAL
MEGA CONFERENCE 2.0



14-15 April 2012

Ball Room | Langham Place Hotel | Mongkok

Organizing Committee

Dr KWOK Po Yin, Samuel *Chairman*

Dr CHAN Chong Pun, Ben
Dr CHAN Chun Kwong, Jane
Dr CHAN On On, Annie
Dr CHAN Wing Wai, Sharon
Dr CHAN Yu Leung, Walter
Dr CHENG Sung Ko, Charles
Dr CHEUNG Yui Shan, Hester
Dr CHOW Pak Chin
Dr FOO Kam So, Stephen
Dr FUNG Kai Bun
Dr HO Chiu Ming
Dr HO Lap Yin
Dr HUNG Wai Ka
Dr KWAN Yiu Keung
Professor LAI Bo San, Paul
Dr LAM Chi Leung, David
Dr LEE Ka Wing, Gavin
Dr LEE Sing Fun, Paul
Dr LEUNG Ping, Maurice
Dr LI Kwok Tung, Donald
Dr LIU King Yin, Rico
Dr LO Fai Man, Ivan
Dr MAH Soo Fan, Ida
Dr TAN Song Tuen
Dr TSANG Wing Hang, Janice
Dr TSE Tak Fu
Dr WONG Chi Keung
Dr WONG Kin Hung, Simon
Dr WONG Yee Hang, Birgitta
Dr YAM Kwong Yui
Dr YUEN Ming Keung
Dr YUNG Wai Hung, Raymond

Dr CHAN Chor Man
Dr CHAN Kuen Ting
Dr CHAN Wai Kong
Dr CHAN Yee Shing
Dr CHENG Hung Fai, David
Dr CHEON Willy Cecilia
Dr CHOW Kwok Fai, James
Dr CHOW Wing Sun
Dr FOO Wai Lum, William
Dr FUNG Tat Chow, Berry
Dr HO Hung Kwong, Duncan
Dr HUI Yee Tak
Dr KAN Chung Sing
Dr LAI Cham Fai
Dr LAI Sik To
Dr LAM Kui Chun
Dr LEE Kin Hung
Dr LEE Yuen Lun
Dr LI Ching Fan, Carina
Dr LING Yu Kong, John
Dr LIU Sung Yu, Herman
Dr LO Richard
Dr SIU Lai Shan, Diana
Dr TONG Pak Chuen
Dr TSE Siu Kwong, Anthony
Dr TSE Yun Tin, Paul
Dr WONG Chi Wai
Dr WONG Kwok Yiu, Chris
Dr WONG Yee Him, John
Dr YAN Wing Wa
Dr YUEN Shi Yin, Nancy



Welcome Message



Dear friends and colleagues,

It gives me great pleasure to present to you the **M³C 2.0** to be held at the Langham Place Hotel on 14 and 15 April 2012. This is an all inclusive medical conference hosted by the Association of Private Medical Specialists of Hong Kong and co-organised by 37 medical specialty societies.

The objective of this **MEGA** conference is to provide up-to-date information and most current views on a broad spectrum of medical diseases and issues. The key organising principle for this conference is to adopt a multidisciplinary approach in the understanding and treatment of diseases. With the great effort of all participating societies, a substantial programme containing many common and important clinical problems and issues is put together in the conference for all participants.

All doctors of any specialties and doctors with general interests as well as allied medical professionals are welcome to this conference to participate and to share your experience with colleagues.

This is the one largest conference that suits both specialists and generalists ever presented in Hong Kong. It is my belief that medicine is still one profession and you should attend this one conference for our profession.

Dr KWOK Po Yin, Samuel

President

Association of Private Medical Specialists of Hong Kong

**MULTI-SPECIALTY
MEDICAL
MEGA CONFERENCE 2.0**



14-15 April 2012

Ball Room | Langham Place Hotel | Mongkok

Floor Plan

Level 8

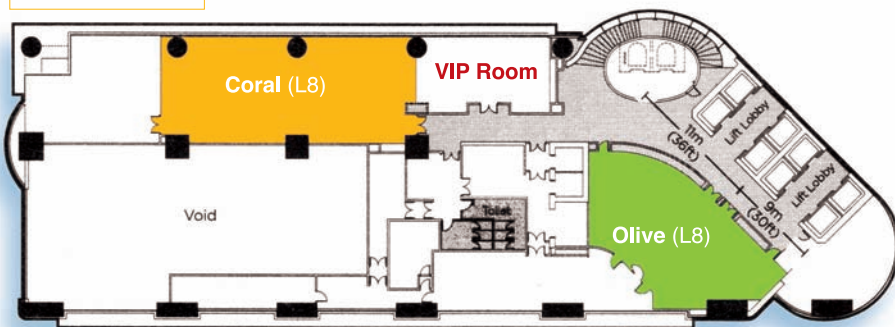

Level 7

Ball Room Level

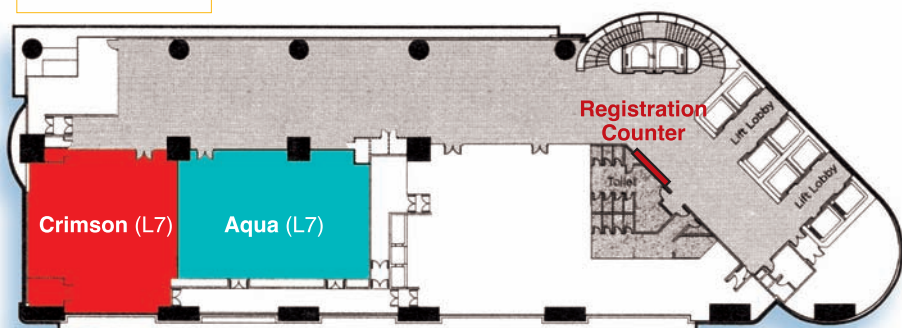

Programme

14 April 2012 **PM** (Saturday) **Tentative Programme**

Session	Gastro-esophageal Reflux Disease	Cancer Screening	Arthritis	Minimal Access Surgery
1330 - 1500	1330 - 1350 Diagnosis and medical treatment Professor WU Che Yuen, Justin	1330 - 1348 Cancer screening: from laboratory to imaging, where are we? Dr YING Chi Ho Anthony	1330 - 1350 Update on the management of rheumatoid arthritis Dr CHAN Tak Hin	1330 - 1350 Endoscopic thyroidectomy - a local experience Dr YAU Kwok Kay, Kelvin
	1350 - 1410 New endoscopic treatment Dr TEOH Yuen Bun, Anthony	1348 - 1406 Cervical cancer screening Dr WONG Ching Yin, Grace	1350 - 1410 Advances in the classification and management of inflammatory back pain Dr CHEUNG Tak Cheong	1350 - 1410 MAS in breast surgery Dr TSANG Yee Yan, Yvonne
	1410 - 1430 Gastro-esophageal reflux disease - Surgical treatment Dr CHAN Kin Chun	1406 - 1424 Breast cancer screening Dr FUNG Po Yan, Eliza	1410 - 1430 New targets and new armamentarium in treatment of gouty arthritis Dr LEE Ka Wing, Gavin	1410 - 1430 Application of robot in liver surgery Dr LAI Chun Hung, Eric
	1430 - 1450 ENT manifestation of gastro-esophageal reflux disease Dr LAM Kin Yip, Paul	1424 - 1442 Colorectal cancer screening Professor LEUNG Wai Keung	1430 - 1450 Practical dietary advices for patient with gouty arthritis Ms LI Heung Ming, Joy	1430 - 1450 Update on single port surgery Dr TEOH Yuen Bun, Anthony
1442 - 1500	Ovarian cancer screening Dr SIU Shing Shun, Nelson			
1500 - 1530 Tea Break				
Session	Liver Diseases	Gynaecological Oncology & Urogynaecology	Ophthalmology	Critical Care
1530 - 1700	1530 - 1550 Approach to problem cases of viral hepatitis B Dr LAI Sik To	1530 - 1548 Fertility sparing treatments in gynaecological cancer Dr TAM Kar Fai	1530 - 1550 Paediatric eye problems that you must know Dr YIP Wai Kuen, Wilson	1530 - 1550 ECMO Dr LOW John
	1550 - 1610 Non-alcoholic liver disease and diabetes mellitus Dr KONG Pik Shan, Alice	1548 - 1606 Palliative care for gynaecological cancer patients Dr SOONG Inda	1550 - 1610 Glaucoma and dry eye - advances in diagnosis and management Dr YUEN Si Yin, Nancy	1550 - 1610 ECMO for H1N1 Dr YAN Wing Wa
	1610 - 1630 Management of HBV in immunosuppressants Professor LAI Ching Lung	1606 - 1624 HPV vaccine Dr TSE Ka Yu	1610 - 1630 Recent development in macular degeneration management Dr FAN Chi Ming, Edward	1610 - 1630 Avian influenza Dr TANG Siu Fai, Bone
	1630 - 1650 Update on the treatment of chronic hepatitis C Dr TSANG Tak Yin, Owen	1624 - 1642 Surgical management of pelvic organ prolapse Dr CHAN Shing Chee, Symphorosa	1630 - 1650 New advances in refractive surgery Dr CHANG So Min, John	1630 - 1650 Life-threatening pneumonia in patients on Rituximab Dr CHAN Chun Kwong, Jane
1642 - 1700		The use of vaginal ring pessary in pelvic organ prolapse Dr LEE Kai Wan		
1700	End of Programme			

Programme

15 April 2012 **AM** (Sunday) Tentative Programme

Session	Acute Stroke Management	Lung Cancer	Implant Dentistry	Cardiology
0900 - 1030	0900 - 0918 Diagnosis of acute stroke Dr WONG Kwok Chu, George	0900 - 0920 Updates on diagnosis of lung cancer Dr LAM Bing	0900 - 0920 Current trend of dental implant therapy Dr LAU Sze Lok, Alfred	0900 - 0920 New insight into treatment of atrial fibrillation Dr FUNG Wing Hong, Jeffery
	0918 - 0936 IV thrombolysis Dr LEUNG Wai Hong, Thomas	0920 - 0940 State-of-the-art surgery for lung cancer Dr MA Chan Chung	0920 - 0940 Radiographic assessment for dental implant surgery Dr LI Ka Lun, Thomas	0920 - 0940 Transcatheter aortic valve implantation (TAVI): QEH Experience Dr CHIANG Chung Sheung
	0936 - 0954 IA thrombolysis Dr WONG Yiu Chung	0940 - 1000 Management of early and locally advanced lung cancer Dr LEE Ho Fun, Victor	0940 - 1000 Bone grafting in implant dentistry Dr CHOW Lop Keung, Raymond	0940 - 1000 Current and updates on treatment of heart failure Dr CHAU Mo Chee, Elaine
	0954 - 1012 Neurosurgical management of intracerebral haemorrhage Dr WONG Chi Chiu, Maurice	1000 - 1020 Towards personalised management of lung cancer Professor MOK Shu Kam, Tony	1000 - 1020 Medical condition in relation to implant dentistry Dr YEUNG Wai Kit, Richie	1000 - 1020 Acute coronary syndrome: What are the current thoughts Dr HO Hung Kwong, Duncan
1030 - 1100	Tea Break			
Session	Colorectal	Prostate Cancer	Oral & Maxillofacial Surgery	Genetics & Diseases
1100 - 1230	1100 - 1118 An algorithm in the management of fistula-in-ano Dr CHUNG Chi Chiu, Cliff	1100 - 1118 Should we screen prostate cancer? How? When? Dr FUNG Tat Chow, Berry	1100 - 1130 Oral pathology and diagnosis Dr TSE Siu Kwong, Anthony	1100 - 1120 Recent advances in molecular diagnosis of common diseases Professor CHAN Nap Yee, Vivian
	1118 - 1136 Common pitfalls in managing inflammatory bowel disease Dr LUK Yiu Wing	1118 - 1136 Contemporary imaging in prostate cancer Dr TAI Kin Shing	1130 - 1200 rh-BMP-2 applications in oral & maxillofacial surgery Dr CHOW Kwok Fai, James	1120 - 1140 Genetic testing of familial cancer syndromes Dr MA Shiu Kwan, Edmond
	1136 - 1154 Trouble shooting in laparoscopic colectomy Dr CHEUNG Yui Shan, Hester	1136 - 1154 Surgical treatment of prostate cancer Dr HOU See Ming, Simon	1200 - 1230 Recent development of 3D technologies in OMFS Dr CHOW Kiang Cheong, Ben	1140 - 1200 Molecular mechanisms and successful target therapies in haematological diseases Professor LEUNG Yu Hung, Anskar
	1154 - 1212 An update on robotic rectal surgery Professor NG Siu Man, Simon	1154 - 1212 Current management of organ confined and locally advanced prostate cancer: role of RT and hormone Dr YAU Tsz Kok	1212 - 1230 Bone complication in prostate cancer (osteoporosis or pathological fracture): prevention and treatment Dr LAM Ying Lee	1200 - 1220 Targeted therapy for solid tumour Professor CHAN Lam, Stephen
1230 - 1330	Lunch			

15 April 2012 **PM** (Sunday) Tentative Programme

Session	Sleep Apnoea	Breast Cancer in Young Women	Back Pain	Dementia
1330 - 1500	1330 - 1350 The current trend in diagnosis and medical treatment of OSA Dr TO Kin Wang	1330 - 1350 Oncoplastic breast conserving surgery Dr CHEUNG Suk Yee, Polly	1330 - 1350 Orthopaedic management of low back pain with or without red flag Dr KWOK Hau Yan	1330 - 1350 Imaging in memory loss Dr CHAN Yu Leung, Walter
	1350 - 1410 Surgical treatment of OSA in adults and children Dr WONG Yee Hang, Birgitta	1350 - 1410 Breast reconstructive options Dr CHEUNG Wing Yung	1350 - 1410 How to prepare individuals with chronic low back pain to adopt a life-long sports? Dr FU Amy	1350 - 1410 How would medications worsen or improve dementia patients? Dr LEE Shun Wah, Jenny
	1410 - 1430 OSA and metabolic dysfunction Dr LAM Chung Mei, Jamie	1410 - 1430 Breast cancer in young women: oncology aspect Dr FOO Wai Lum, William	1410 - 1430 Occupational therapy in low back pain management Ms WONG Hei Yi	1410 - 1430 How can treatment be given to an adult patient incapable of giving consent Dr CHEUNG Hung Kin
	1430 - 1450 Sleep disorder Professor WING Yun Kwok	1430 - 1450 Overview of fertility preservation options Dr LI Hang Wun, Raymond	1430 - 1450 Rationale and options of interventional pain management Dr LI Ching Fan, Carina	1430 - 1450 Management of swallowing problem in end stage dementia patients Ms CHAN Pik Ha, Christina
1500 - 1530	Tea Break			
Session	Irritable Bowel Syndrome	Palliative Care	Geriatric Fracture	Diabetes
1530 - 1700	1530 - 1550 Updates on irritable bowel syndrome Dr CHAN On On, Annie	1530 - 1550 Update on management of cancer pain Dr KWOK Oi Ling, Annie	1530 - 1550 Fragility fracture: principle of management and pitfalls Dr HO Sheung Tung	1530 - 1550 Update on anti-diabetic drugs Dr LEE Ka Kui
	1550 - 1610 Microflora and irritable bowel syndrome Dr YUNG Wai Hung, Raymond	1550 - 1610 ABC of breaking bad news Dr LIU King Yin, Rico	1550 - 1610 Anaesthetic preparation and complications for fragility fracture surgery on hip & long bone Dr CHAN Hing Tsuen	1550 - 1610 Glycaemic control during pregnancy Professor LAO Tzu Hsi, Terence
	1610 - 1630 Psychiatry and irritable bowel syndrome Professor MAK Dun Ping, Arthur	1610 - 1630 Advance directives: Their role in clinical practice and the difficulties Dr TSE Chun Yan	1610 - 1630 Fragility hip fracture surgery- Can it be minimally invasive? Dr LAU Chi Yuen	1610 - 1630 Screening and management of diabetic retinopathy Dr CHAN Wai Nang, Clement
	1630 - 1650 Dietary management in irritable bowel syndrome Ms CHAN June	1630 - 1650 End of life care pathway for dying patients Dr LAM Po Tin	1630 - 1650 Post operation rehabilitation and fall prevention in fragility hip fracture Dr CHAN Tak Yeung	1630 - 1650 Can we prevent CAD in type 2 diabetes? Dr LEUNG Tat Chi, Godwin
1700	End of Programme			

Platinum sponsors:



Golden sponsors:



Otsuka Pharmaceutical (H.K.) Ltd.

Silver sponsors:



Other sponsors:



Bristol-Myers Squibb Pharma (HK) Ltd.

By fax : 2899 2267 (Attn: May Cheung)
By E-mail : info@mmmcon.com
By Mail : 4/F., 9 Queen's Road Central, Central, Hong Kong **(Attn: May Cheung)**

I would like to register for the M³C:-

Name : _____
Post : _____
Institution / Organization : _____
Tel : _____ Email : _____
Address : _____

I am member of one of the following organizations.

(Please ✓ as appropriate)

- | | |
|--|--|
| <input type="checkbox"/> The Society of Anaesthetists of Hong Kong | <input type="checkbox"/> Hong Kong Association for the Study of Liver Diseases |
| <input type="checkbox"/> Hong Kong Society of Breast Surgeons | <input type="checkbox"/> The Hong Kong Medical Association |
| <input type="checkbox"/> The Hong Kong Cancer Therapy Society | <input type="checkbox"/> Hong Kong Society of Medical Genetics |
| <input type="checkbox"/> Hong Kong College of Cardiology | <input type="checkbox"/> Hong Kong Society of Minimal Access Surgery |
| <input type="checkbox"/> American College of Chest Physicians (HK & Macau Chapter) | <input type="checkbox"/> The Hong Kong Neurosurgical Society |
| <input type="checkbox"/> Hong Kong Society of Clinical Oncology | <input type="checkbox"/> The Obstetrical and Gynaecological Society of Hong Kong |
| <input type="checkbox"/> Hong Kong Society for Coloproctology | <input type="checkbox"/> Hong Kong Ophthalmological Society |
| <input type="checkbox"/> Hong Kong Society of Critical Care Medicine | <input type="checkbox"/> The Hong Kong Association of Oral and Maxillofacial Surgeons |
| <input type="checkbox"/> Hong Kong Dental Association | <input type="checkbox"/> The Hong Kong Orthopaedic Association |
| <input type="checkbox"/> The Hong Kong Society of Diagnostic Radiologists | <input type="checkbox"/> Hong Kong Society of Otorhinolaryngology Head & Neck Surgery |
| <input type="checkbox"/> Hong Kong Society of Endocrinology, Metabolism & Reproduction | <input type="checkbox"/> Hong Kong Society of Palliative Medicine |
| <input type="checkbox"/> The Hong Kong Society of Gastroenterology | <input type="checkbox"/> Hong Kong Society of Plastic, Reconstructive and Aesthetic Surgeons |
| <input type="checkbox"/> The Hong Kong Geriatrics Society | <input type="checkbox"/> The Hong Kong Society of Psychiatrists |
| <input type="checkbox"/> The Hong Kong Society of Haematology | <input type="checkbox"/> The Hong Kong Society of Rheumatology |
| <input type="checkbox"/> Hong Kong Society of Hepatobiliary and Pancreatic Surgery | <input type="checkbox"/> Hong Kong Thoracic Society |
| <input type="checkbox"/> Hong Kong IBD Society | <input type="checkbox"/> Hong Kong Society of Upper Gastrointestinal Surgeons |
| <input type="checkbox"/> The Hong Kong Society for Infectious Diseases | <input type="checkbox"/> The Hong Kong Urogynaecology Association |
| <input type="checkbox"/> The Hong Kong Society of Interventional Radiology | <input type="checkbox"/> Hong Kong Urological Association |

I enclose herewith a cheque of

HK\$100 (Member of any one of the above named organizations) /

HK\$200 (Non-member) /

HK\$100 (Nursing Colleagues)

Payable to "Association of Private Medical Specialists of Hong Kong Ltd."

Cheque No. : _____ Issuing Bank : _____

Date : _____

Stamp
here

**MULTI-SPECIALTY
MEDICAL
MEGA CONFERENCE 2.0**

4/F., 9 Queen's Road Central,
Central, Hong Kong
Attn: May Cheung

**MULTI-SPECIALTY
MEDICAL
MEGA CONFERENCE 2.0**

14-15 April 2012

Ball Room | Langham Place Hotel | Mongkok



Enquiry

Ms May Cheung

Email | info@mmmcon.com

www.mmmcon.com